



Sussex County Horse Show
Ranch Extravaganza
August 7, 2022



SCCHS Ranch Extravaganza

August 7, 2022

Main Ring - 8:30 a.m.

Class

1 In Hand - Mare

2 In Hand - Geldings/Stallion

*****15 Minute Break*****

3 Ranch Pleasure - Walk Trot - OPEN

4 Ranch Pleasure - Walk Trot - NON PRO

5 Ranch Pleasure - Walk Trot - YOUTH

6 Ranch Pleasure - Walk Trot - NOVICE

7 Ranch Pleasure - Walk Trot - PRIME TIME

8 Ranch Pleasure - Walk Trot Lope - OPEN

9 Ranch Pleasure - Walk Trot Lope - NON PRO

10 Ranch Pleasure - Walk Trot Lope - YOUTH

11 Ranch Pleasure - Walk Trot Lope - NOVICE

12 Ranch Pleasure - Walk Trot Lope - PRIME TIME

12A Leadline

13 Ranch Riding - Walk Trot - OPEN

14 Ranch Riding - Walk Trot - NON PRO

15 Ranch Riding - Walk Trot - YOUTH

16 Ranch Riding - Walk Trot - NOVICE

17 Ranch Riding - Walk Trot - PRIME TIME

18 Ranch Riding - Walk Trot Lope - OPEN

19 Ranch Riding - Walk Trot Lope - NON PRO

20 Ranch Riding - Walk Trot Lope - YOUTH

21 Ranch Riding - Walk Trot Lope - NOVICE

22 Ranch Riding - Walk Trot Lope - PRIME TIME

23 Ranch Trail - Walk Trot - OPEN

24 Ranch Trail - Walk Trot - NON PRO

25 Ranch Trail - Walk Trot - YOUTH

26 Ranch Trail - Walk Trot - NOVICE

27 Ranch Trail - Walk Trot - PRIME TIME

28 Ranch Trail - Walk Trot Lope - OPEN

29 Ranch Trail - Walk Trot Lope - NON PRO

30 Ranch Trail - Walk Trot Lope - YOUTH

31 Ranch Trail - Walk Trot Lope - NOVICE

32 Ranch Trail - Walk Trot Lope - PRIME TIME

*****15 Minute Break*****

33 Ranch Round Up - Walk Trot - OPEN

34 Ranch Round Up - Walk Trot - NON PRO

35 Ranch Round Up - Walk Trot - YOUTH

36 Ranch Round Up - Walk Trot - NOVICE

37 Ranch Round Up - Walk Trot - PRIME TIME

38 Ranch Round Up - Walk Trot Lope - OPEN

39 Ranch Round Up - Walk Trot Lope - NON PRO

40 Ranch Round Up - Walk Trot Lope - YOUTH

41 Ranch Round Up - Walk Trot Lope - NOVICE

42 Ranch Round Up - Walk Trot Lope - PRIME TIME

***** Lunch Break*****

Show Date: 8/7/2022

2022 Sussex County Horse Show
ECRRA – All Region Extravaganza



Day Stalls _____ @ \$35.00 per horse stall Overnight stalls _____ @ \$60.00 Tack Stalls _____ @ \$35.00 per tack stall
Shavings: _____ @ \$10.00/bag Camper fee _____ days @ \$35.00 Back # _____

Rider Info:

Horse Info: Stallion Gelding Mare
Breed: _____ Age: _____ Rider Last Name: _____ Rider First Name: _____
Horse's Name: _____ Address: _____
ECRRA Member Yes No City: _____ State: _____ Zip: _____ Phone: _____ DOB: _____
Barn or Trainer you are with Email: _____ Rider Division(s): _____

Waiver: The undersigned releases the lessors of the property on which the equine event is being held & SCHS., as the sponsor of the event from any liabilities resulting from injuries, illness or damage incurred to person, animal or property by the undersigned, by members of his/her family, or by any other spectator, participant, or animal while attending this event. Also, SCHS. will not be liable for any damage to or failure of equipment while at this event. I, the undersigned, concur that equine animal activities involve risks that are essentially impractical or impossible for SCHS. to prevent or eliminate; and that those inherent risks of an equine activity must be borne by those who engage in those equine activities. This signed class entry form will be retained by SCHS. and made a part of the event's entry records. This signed waiver applies to all phases of this event.

I have read and understand the terms of this waiver (Rider under 18 years must have Parent/Guardian Sign)

CLASS FEES:

Regular Classes - \$15.00/class
Leadline Class- \$12.00/class
Office Fee \$15.00 pre-entry/\$20.00 post entry --applied to every back number
Usage Fee \$5.00 – applied to every back number
Payment Types – Visa/Mastercard/Check
Card # _____ Exp / _____ Code _____

PRE ENTERIES ARE DUE BY AUGUST 3, 2021

PRE ENTERIES CAN EMAILED IN A PDF FORMAT TO: Lori Wunderlich @ wunspot@aol.com or to 55 Carriage Lane, Newton, NJ 07860 these entries must have payment information included. Her phone number is 973-670-9290.

Note: Exhibitor is asked to close out bill in person. 30 min after conclusion of show, office will start close process. Any Exhibitor found to owe monies to SCHS due to discrepancies, will be sent a bill which must be settled prior to entering into future shows

Please Circle classes you are entering

In-Hand Classes	1 – Mares 2 – Geldings/Stallions
Leadline (8&U)	12A
Open Walk/Trot	3, 13, 23, 33
Non-Pro Walk/Trot	4, 14, 24, 34
Youth Walk/Trot	5, 15, 25, 35
Novice Walk/Trot	6, 16, 26, 36
Prime Time Walk/Trot	7, 17, 27, 37
Open Walk/Trot/Lope	8, 18, 28, 38
Non-Pro Walk/Trot/Lope	9, 19, 29, 39
Youth Walk/Trot/Lope	10, 20, 30, 40
Novice Walk/Trot/Lope	11, 21, 31, 41
Prime Time Walk/Trot/Lope	12, 22, 32, 42



SCHS RANCH EXTRAVAGANZA
OPEN, YOUTH, NON-PRO, PRIMETIME – LEADLINE

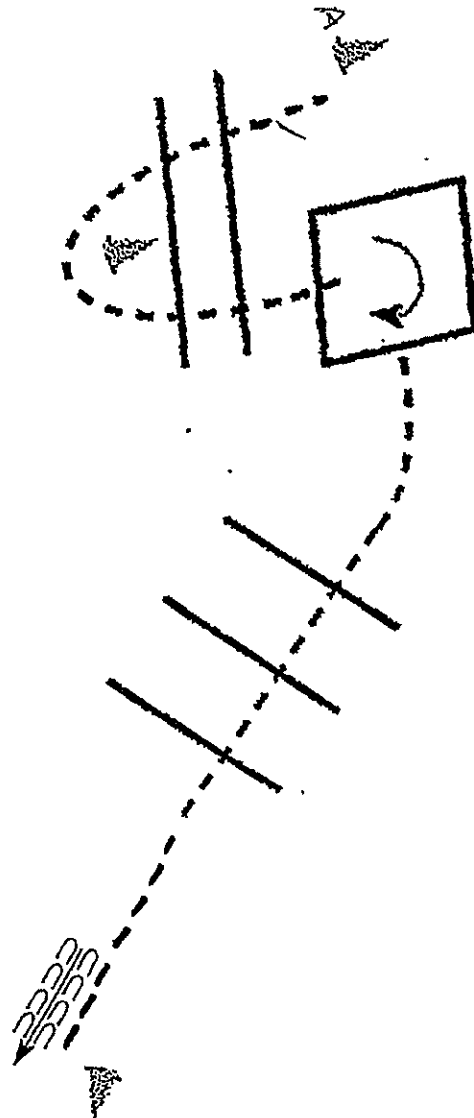

Be Ready At A

1. Walk over poles and around cone into box
2. In box make a 90 degree turn to right
3. Walk out of box and walk over 3 poles
4. Stop at cone and back 4 steps



SCHS RANCH EXTRAVAGANZA
OPEN, YOUTH, NON-PRO, PRIMETIME – WALK/TROT

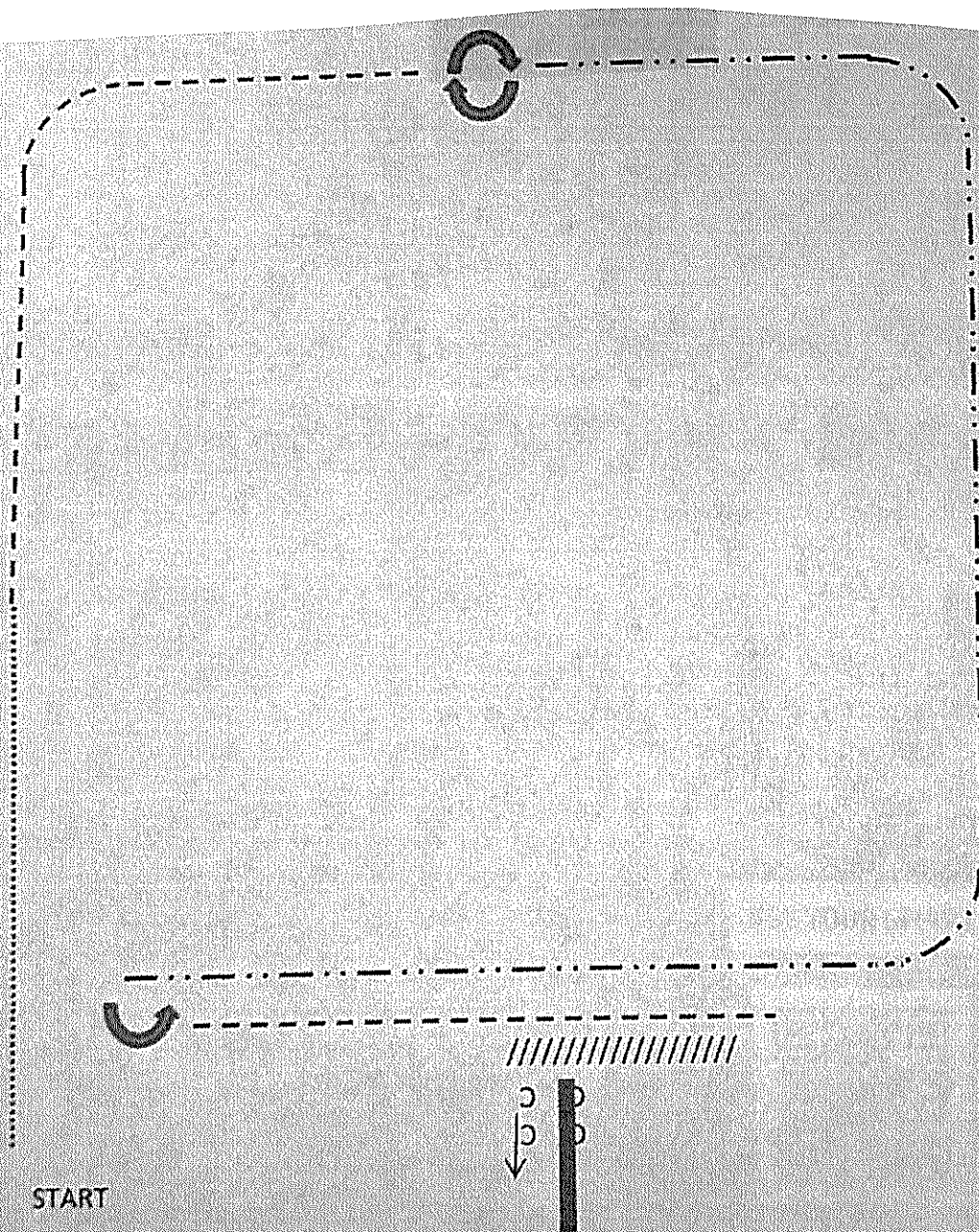

START

USE ONLY 1/2 of Arena

- | | |
|------------------|--------------------------|
| 1. Walk | 5. Stop, 180 Left |
| 2. Trot | 6. Trot, past center |
| 3. 360 Right | 7. Stop & Back to center |
| 4. Extended Trot | 8. Side Pass Rail Right |

WALK	-----
TROT	- - - - -
EXT TROT	—————



SCHS RANCH EXTRAVAGANZA

OPEN, YOUTH, NON-PRO, PRIMETIME – WALK/TROT/LOPE

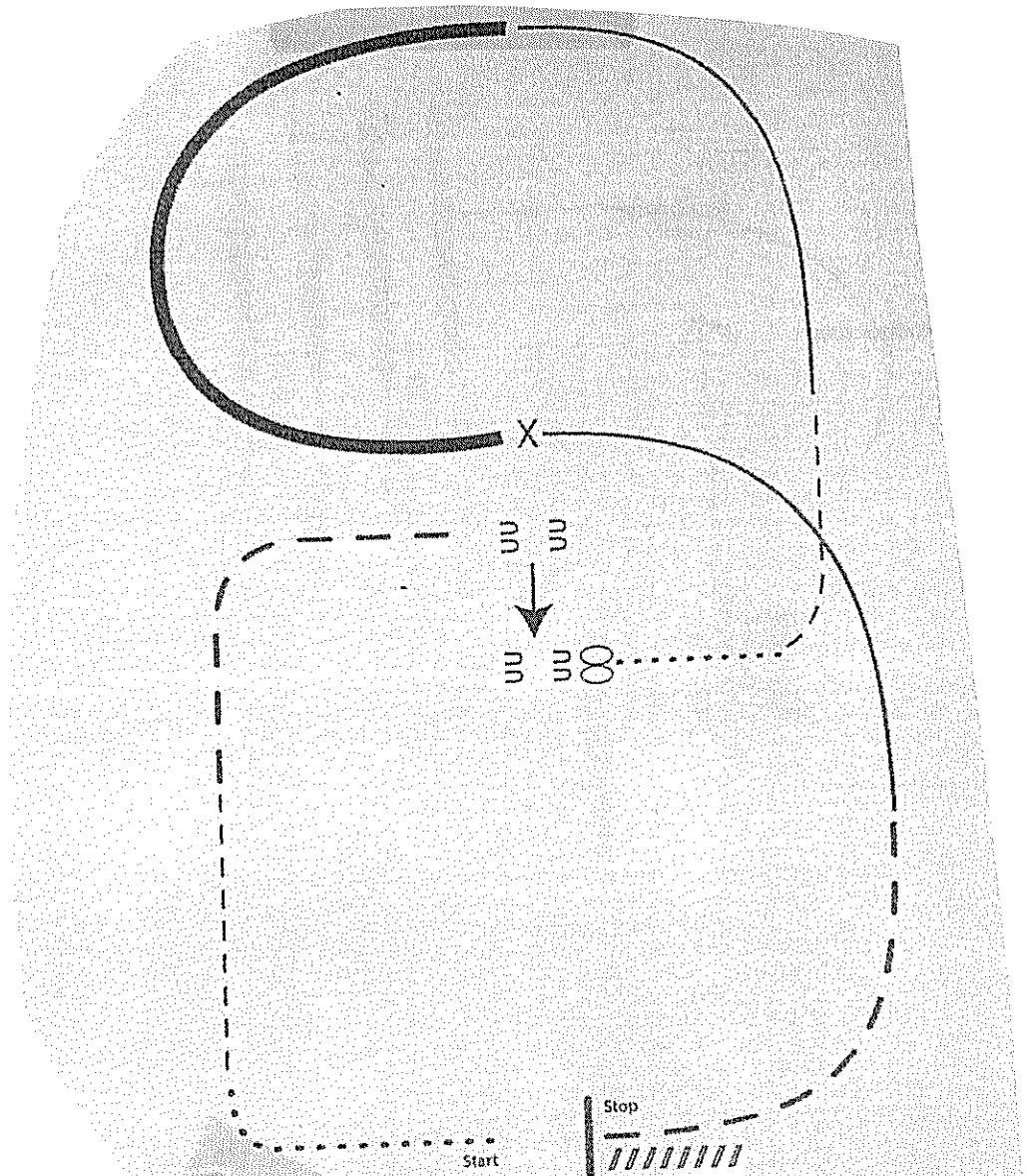

1. Walk to the left around corner of the arena
2. Trot
3. Extend alongside of the arena and around the corner to center
4. Stop, side pass right
5. 360 degree turn each direction (either way 1st)
6. Walk
7. Trot
8. Lope left lead
9. Extend the lope
10. Change leads (simple or flying)
11. Collect to the lope
12. Extend Trot
13. Stop and back

- X Lead Change
- Walk
- - - Trot
- - - - Ext Trot
- Lope
- Ext Lope
- //// //// Back
- S S Sidepass



SCHS RANCH EXTRAVAGANZA OPEN, YOUTH, NON-PRO, PRIMETIME – TRAIL

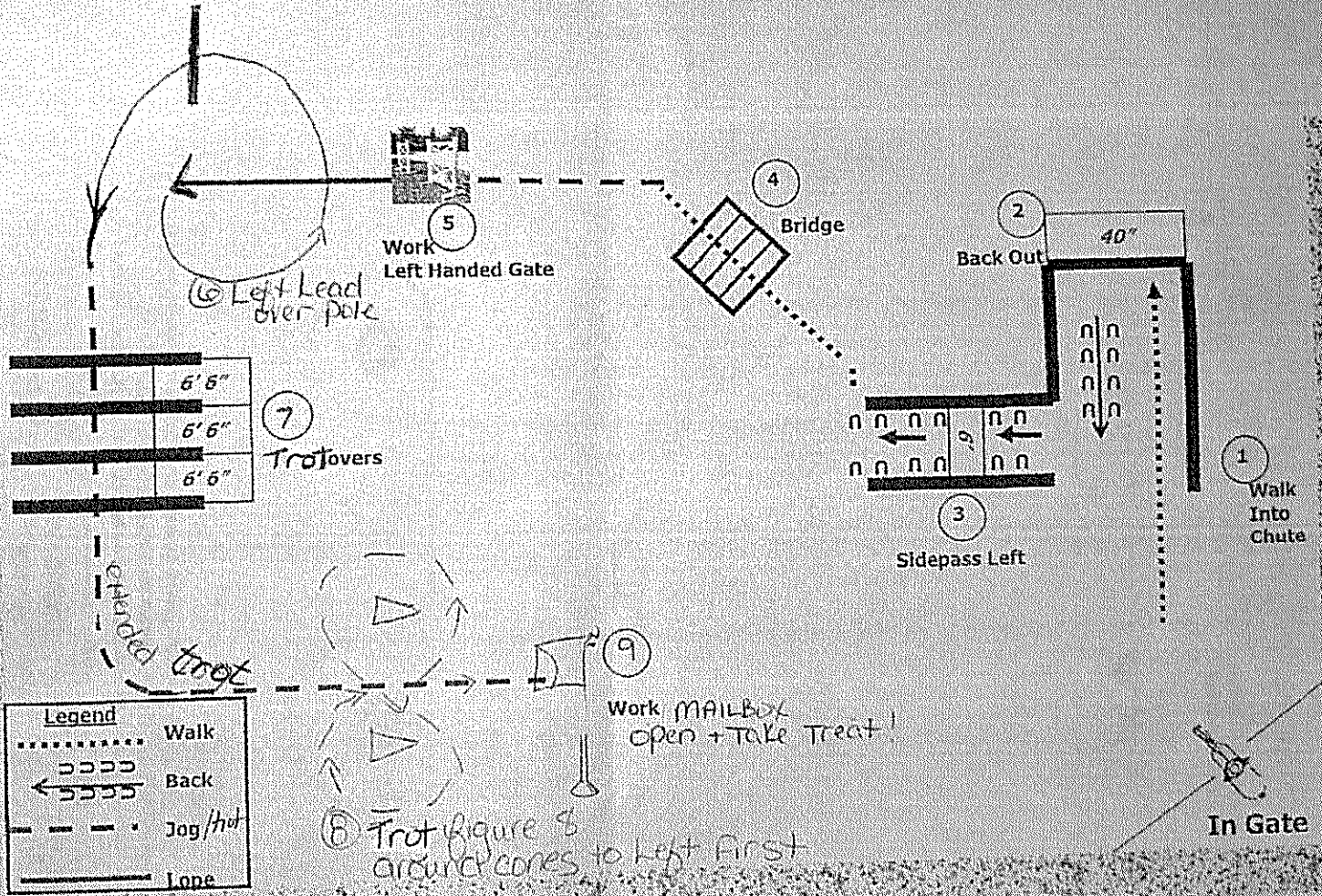

w/T: replace Lope with an extended trot



SCHS RANCH EXTRAVAGANZA

OPEN, YOUTH, NON-PRO, PRIMETIME – ROUND-UP

Run pattern as drawn. May start on either side. Knockdown of any obstacle is a 5 point penalty for each knockdown, All walk trot exhibitors. loping more then 3 strides in the pattern, going off pattern is a disqualification

